

Integrated Control Box

JCB35M12



Data sheet

JCB35M12



JCB35M12B



JCB35M12C

- JCB35M12 is an integrated control box. Its surface is etched with lines, which makes it feel delicate and the buttons have obvious pattern distinctions. It can be used with a standing desk in an office or home environment, and the height of the desk can be adjusted with a simple operation button.

At the same time, JCB35M12 has the following two models:

JCB35M12B: Up, Down, LED display, Type A charging port

JCB35M12C: Up, Down, LED display, 3 memory positions, Type A charging port, Type C charging port, Child lock button

Features

- Integrated control box
- The elastic arm design maximizes the gap around the button, and the button surface graphics can be customized.
- Using LED digital tube display
- Front can be customized LOGO
- The right side of JCB35M12B is the Type-A charging port, and the charging output is: 5V 2A
- The left and right sides of JCB35M12C are Type-C charging port and Type-A charging port. When the two charging port are used at the same time, 5V 2A is used by shunt; when a single charging port is used, the charging output is: 5V 2A

Usages

- Supporting column: column model/color/stroke/height/speed/number of stage can be selected according to requirements
- Ambient surrounding: Indoor
- Storage and transport temperature: -25℃~70℃
- Optional adapters and columns:

Adapter model	Input voltage	Stage of the column	Speed	Load	Motor
JCP35PA-B-3-29V/ 2A-PAGC-4G2	110/220V	2	25mm/s	80Kg	Ten slots
JCP35PA-B-3-32V/ 2.12A-PAGC-4G2	110V	2	30mm/s	80Kg	Ten slots
	220V	3	30mm/s	80Kg	0042
	110V	3	30mm/s	70Kg	0042
JCP35PA-B-3-29V/ 2A-PAGC-4G2 (S1393)	220V	3	30mm/s	100Kg	Ten slots
	220V	3	35mm/s	80Kg	0042

customizable LOGO area

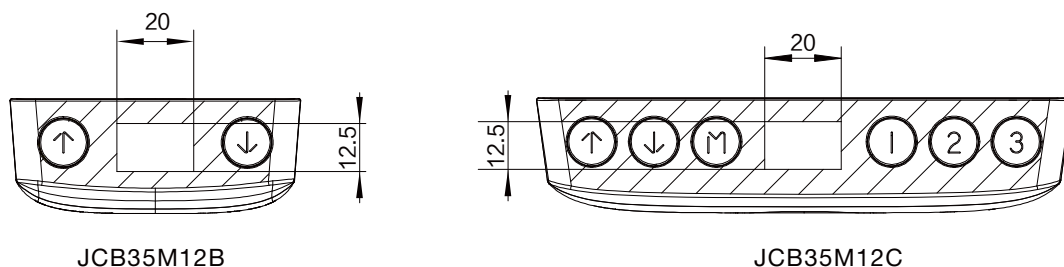

The section line in the figure is the customizable LOGO area

Dimensions

JCB35M12B

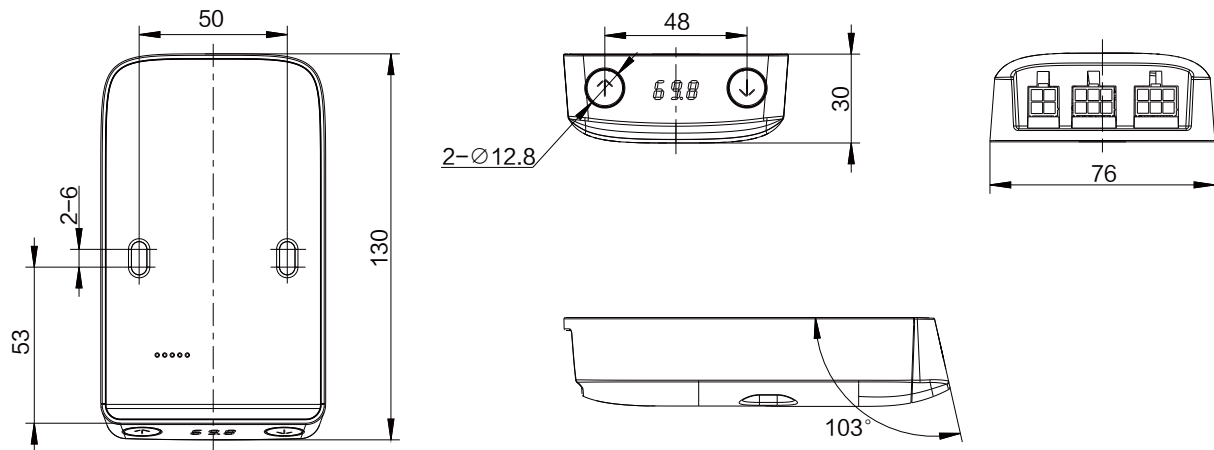

JCB35M12C

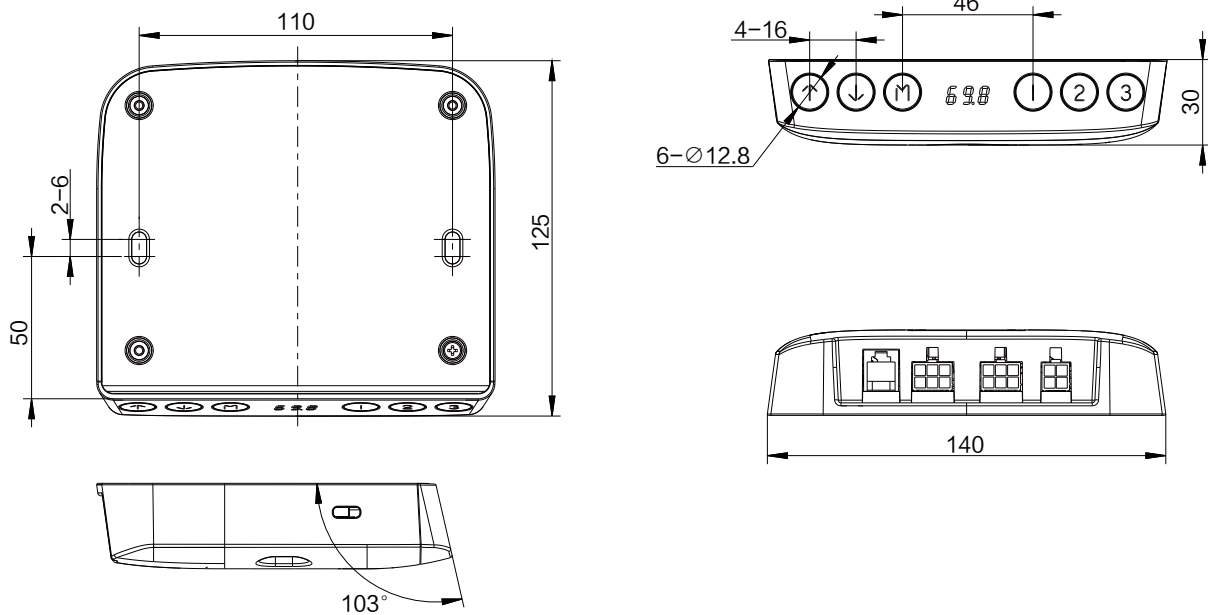

Product installation drawing

JCB35M12B

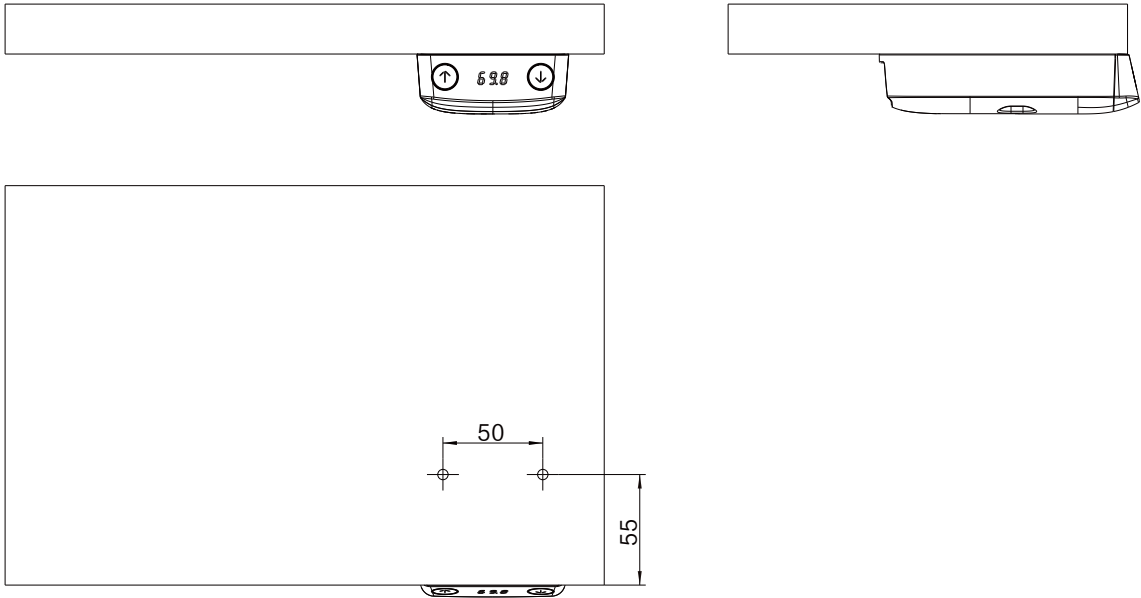

JCB35M12C

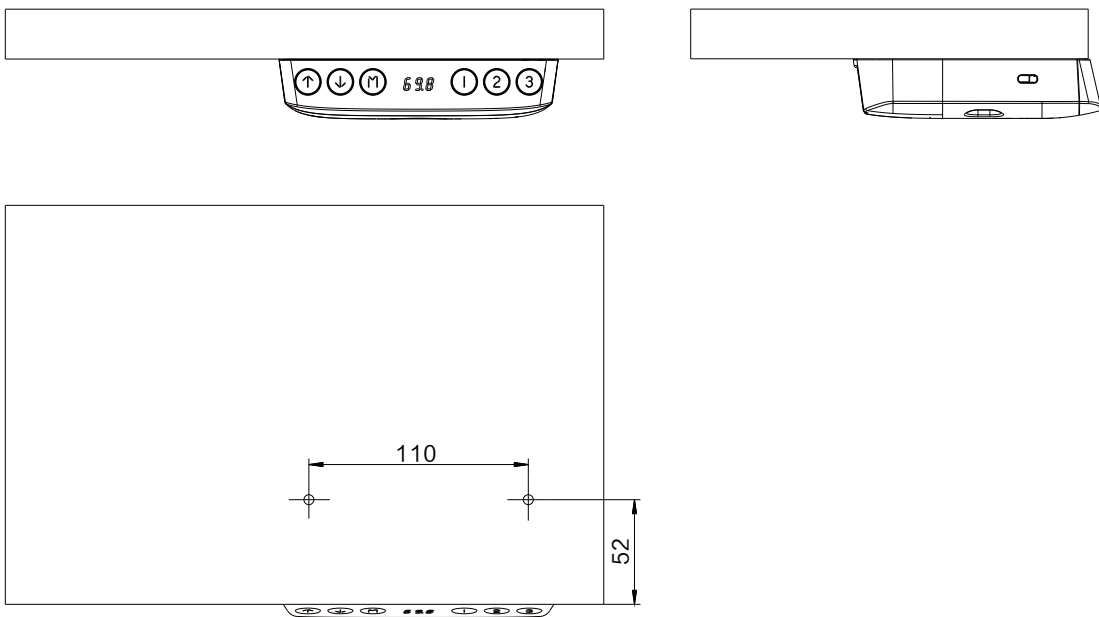

Ordering Key

JCB35M12C-2E7-5-0-0-500(495)650(700)

