

# JC35L23 Linear Actuator

Application field - Medical Line  
 Preferably in medical beds and etc.

JC35L23 is an actuator with quick release function, and it has following specifications:JC35L23-6000N(push). Features: release lightly ,the IP grade is IPX6, and low noise, Suitable for medical bed system and etc.



## General Features

<b>Dynamic load push (N):</b>	6000
<b>Motor rated voltage Input (VDC):</b>	29
<b>Stroke length (mm):</b>	6000N: 50-300mm
<b>Retracted length(mm):</b>	L=S+185(50 ≤ S ≤ 300) L=S+195(50 ≤ S ≤ 300,with anti-pitch option)
<b>Colour:</b>	Black (RAL 9005) or Grey (RAL 7035)
<b>Limit Switch:</b>	Built-in (electrical)
<b>Noise level:</b>	≤48dB (Environmental noise ≤40dB)
<b>Quickly release:</b>	Standard
<b>Weight:</b>	2.8kg (stroke length/installation dimensions: 200/395mm) (different stroke length and installation dimensions with different weight)
<b>Static bending load:</b>	No bending load
<b>Duty cycle:</b>	10%, max. 2min. continuous use
<b>Max IP grade:</b>	IPX6
<b>Options:</b>	Safety nut, hall sensor option, anti-pitch option
<b>Standards:</b>	IEC60601-1: 2012 EN 60601-1:2006+A12:2014 ANSI/AAMI ES60601-1:2005/(R)2012 and A1:2012, C1:2009/(R)2012 and A2:2010/(R)2012

## Dimension Drawing

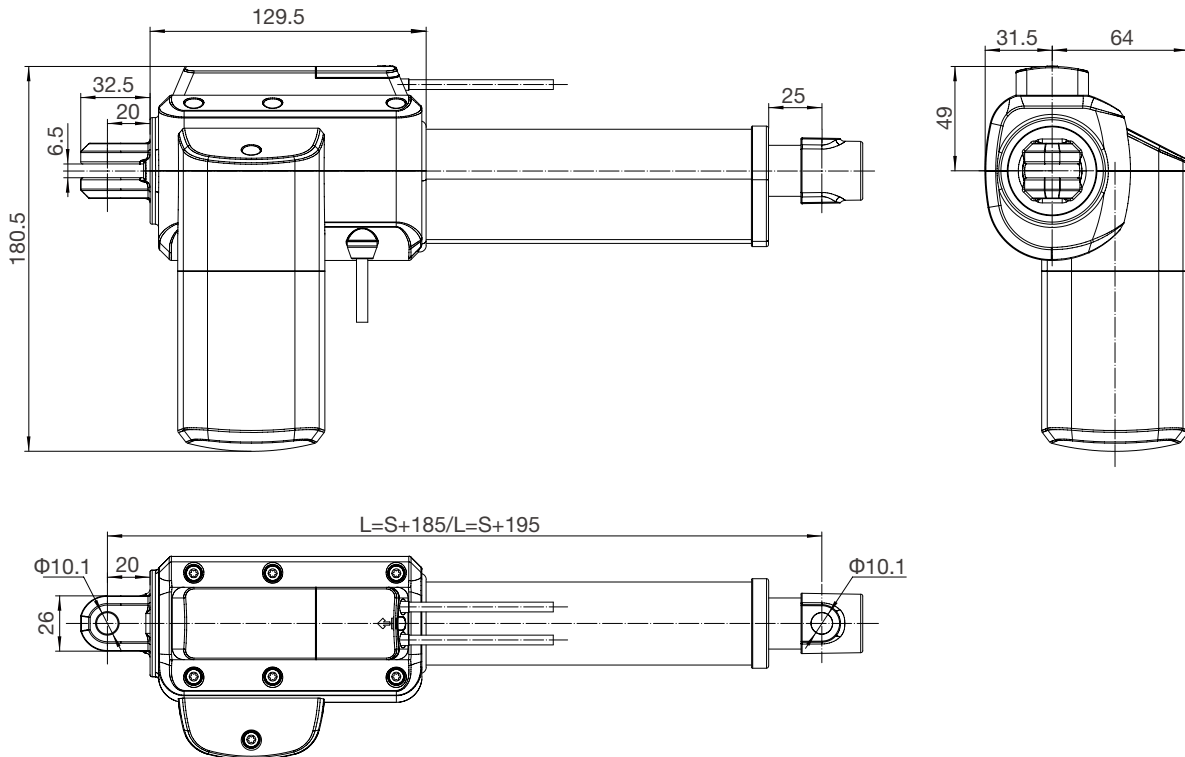

## Technical parameters

Power voltage (VDC)	Spindle pitch (mm)	Max.Load capacity (N)	Self locking (N)	Speed no load (mm/s)	Speed full load (mm/s)	Current no load (A)	Current full load (A)
24	6	6000	6000	5.7	4.3	0.5	3.7
29	6	6000	6000	7.0	5.5	0.5	3.8
36	6	6000	6000	9.0	7.3	0.4	4.0

Remark: the above data are typical values at 25 °C

## Stroke length versus load

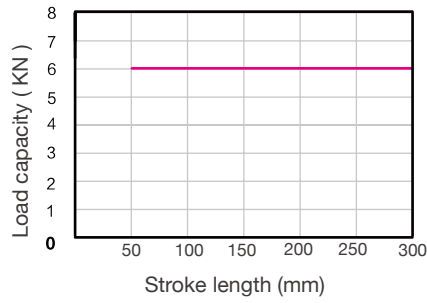

## Characteristic

- Typical speed ————
- Min. speed - - - - -
- Typical current ————
- Max. current - - - - -

**6000N**

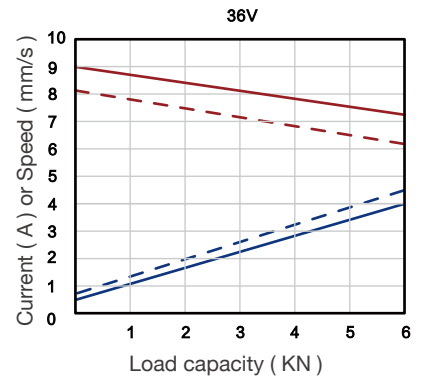
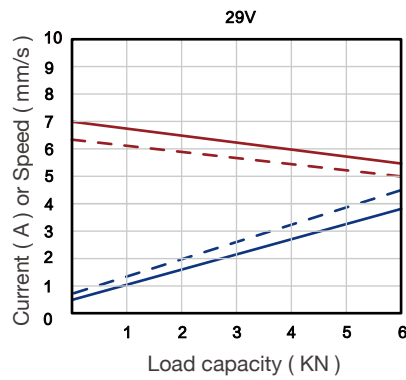
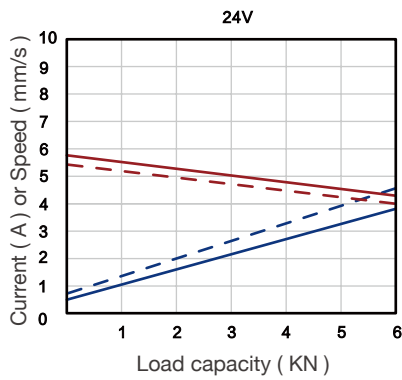

## Ordering Key

Take **JC35L23P65D529150/345HG32L160021D5** for example

Model	<b>JC35L23</b>	
Optional features	<b>P</b>	0 = Standard quick release function / P = Only push no pull option S = Safety nut / Y = Double hall sensor option PY = Only push no pull option+Double Hall sensor option SY = Safety nut+Double Hall sensor option
Load in push	<b>6</b>	6 = 6000N
Speed at full load	<b>5D5</b>	4D5 = 4.5mm/s 5D5 = 5.5mm/s 7 = 7mm/s
Input voltage	<b>29</b>	24 = 24VDC 29 = 29VDC 36 = 36VDC
Stroke length/ Installation dimension	<b>150/345</b>	Stroke length = XXX Installation dimension = XXX
Clevis directions	<b>H</b>	H = H direction / V = V direction
Color	<b>G</b>	G = Grey (RAL7035) / B = Black (RAL9005)
End clevis specification	<b>32</b>	32 = B32,slot 6.5, depth 29.5,padded cover aperture 10.1
End clevis material	<b>L</b>	L = Aluminum alloy
Top clevis specification	<b>16</b>	16 = F16,the hole of inner tube is $\phi$ 14.2, the hole is 17mm far from the end, add JC35L22 plastic cushion cover, $\phi$ 14.2. Add JC35L22 cushion cover; add D inner tube front pull sleeve (white)
Brake specification	<b>0</b>	0 = No brake
Type of plug and cable	<b>02</b>	02 = 4-pin DIN plug 10 = 5 pin DIN plug 93 = 6 pin Molex elbow plug
Cable length	<b>1D5</b>	2D0 = 2m / 1D5 = 1.5m

## Ordering Details

### Dimension drawing of clevis

End clevis: B32

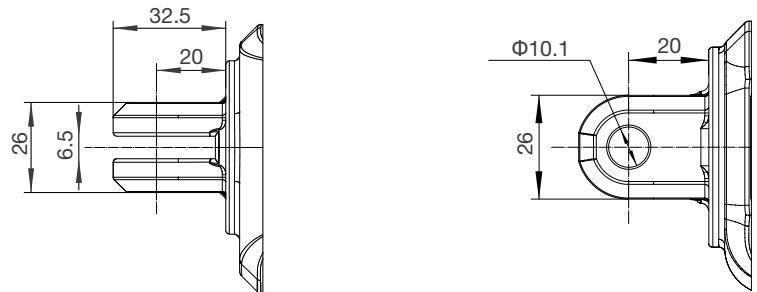

Top clevis: F16

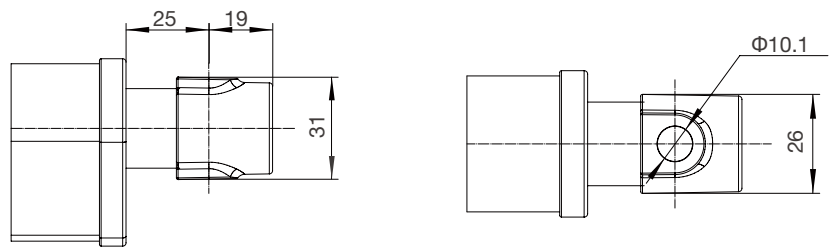

### Dimensions JC35L23 with control box

JCB35Q install on JC35L23

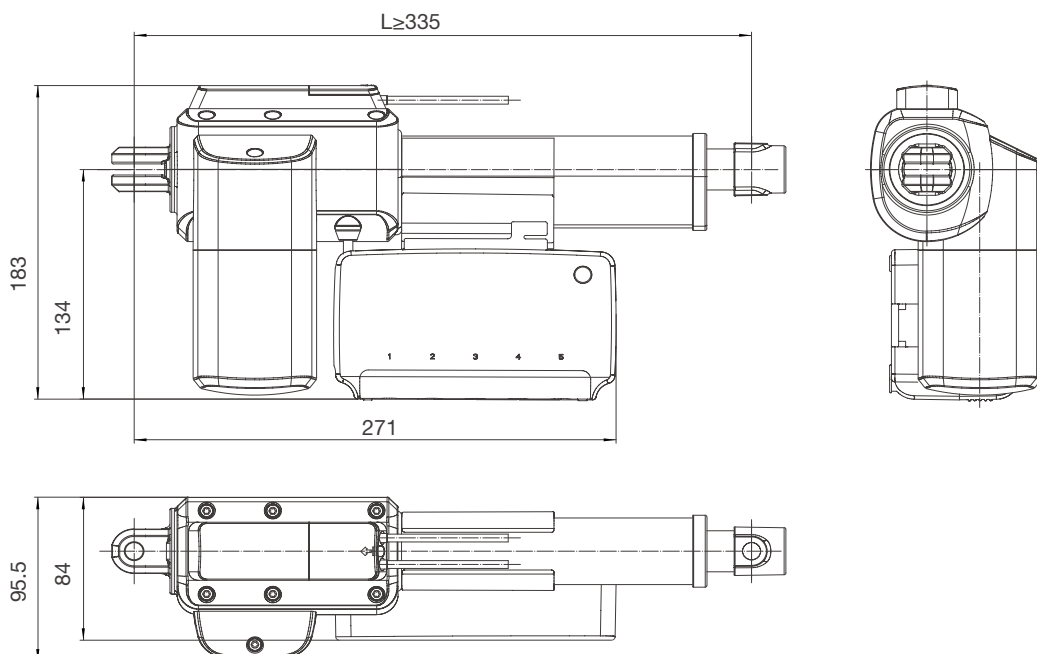

JCB35T install on JC35L23

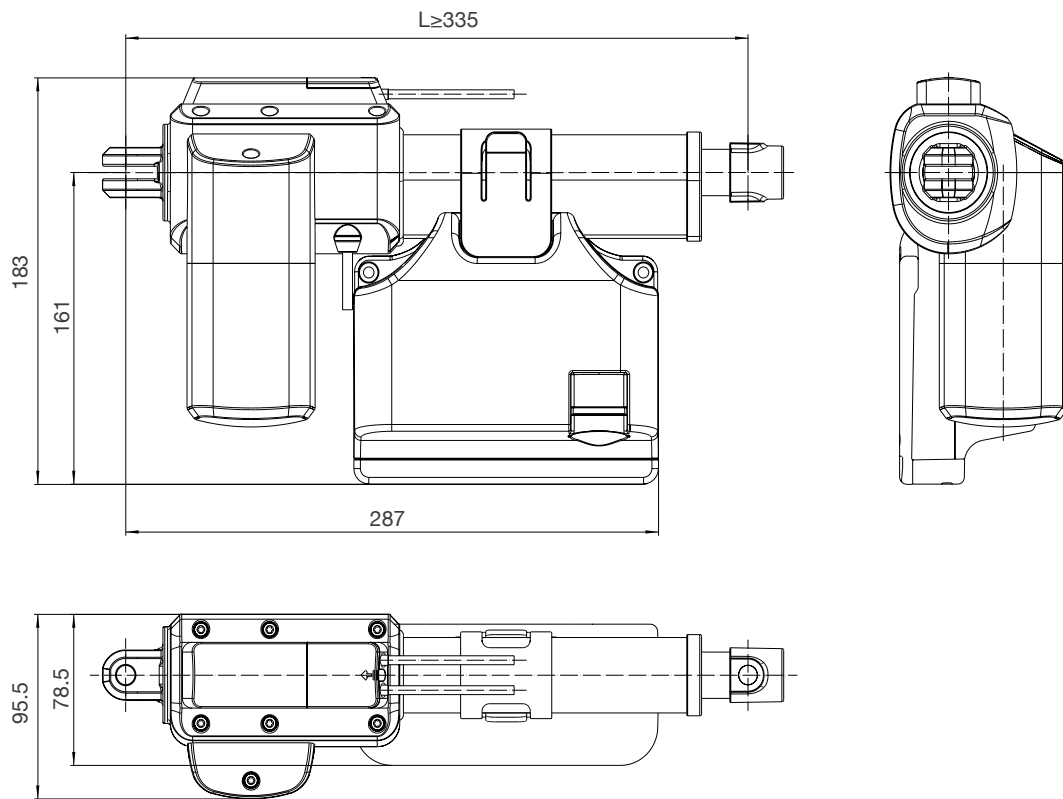

JCB35T2 install on JC35L23

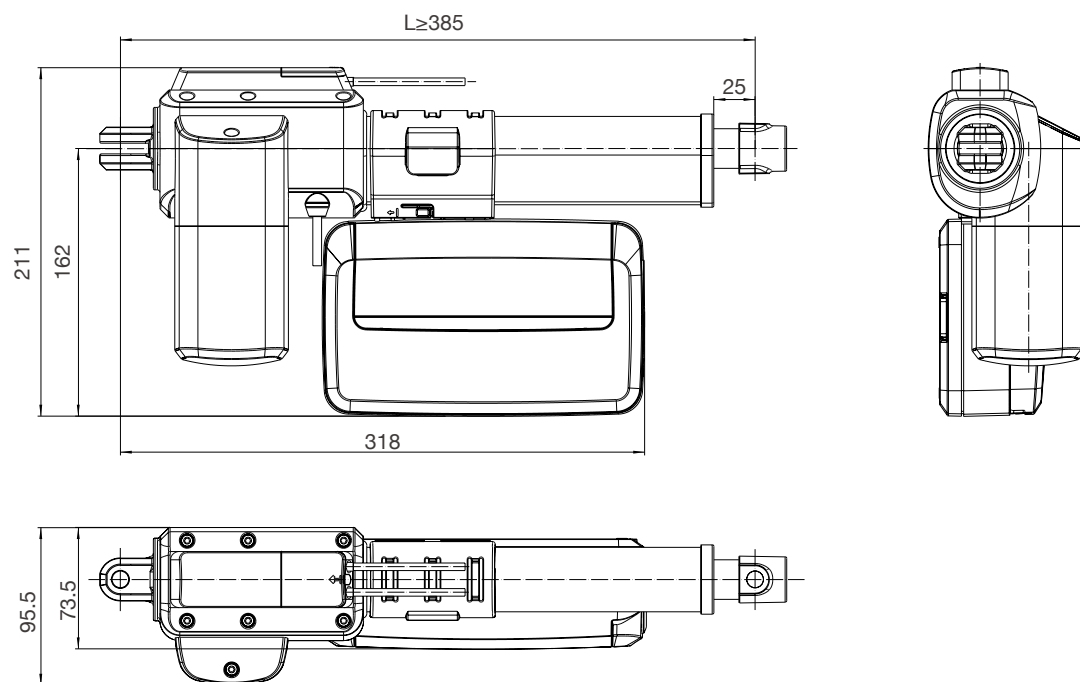

**Motor wire**

**4-pin straight plug (standard)**

Matching controller: JCB35Q/  
JCB35T/ JCB35R/ JCB35R1/  
JCB35S/ JCB35K2

Pin	Color	Function
1	NC	Not connected
2	Brown	When positive voltage power on, actuator will go down
3	Blue	When positive voltage power on, actuator will go up
4	NC	Not connected
Outer ring	NC	Not connected

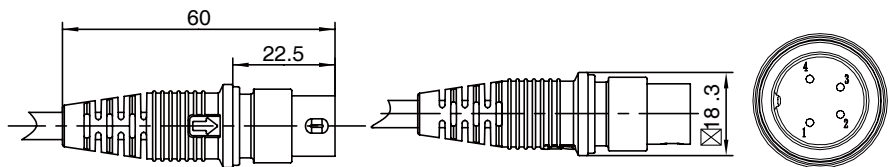

**5 pin DIN plug  
(with Hall sensor)**

Matching controller: JCB35Q/  
JCB35T/ JCB35R/ JCB35R1/  
JCB35S/ JCB35K2

Pin	Color	Function
1	Red	5V
2	Brown	When positive voltage power on, actuator will go down
3	Black	GND
4	Blue	When positive voltage power on, actuator will go up
5	Yellow	Hall signal 1
Outer ring	Orange	Hall signal 2

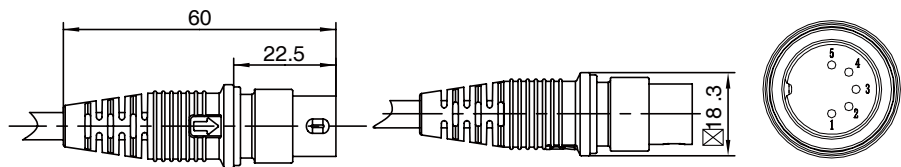

### 6 Pin Mini-Fit elbow plug

Matching control box :JCB35T2/  
JCB35T3/JCB35Q3/JCB35K3

Pin	Color	Function
1	Orange	When not on lower limit, link with red wire
2	Black	When not on upper limit, link with yellow wire
3	Red	When not on lower limit, link with orange wire
4	Brown	When positive voltage power on,actuator will go down
5	Blue	When positive voltage power on,actuator will go up
6	Yellow	When not on upper limit, link with black wire

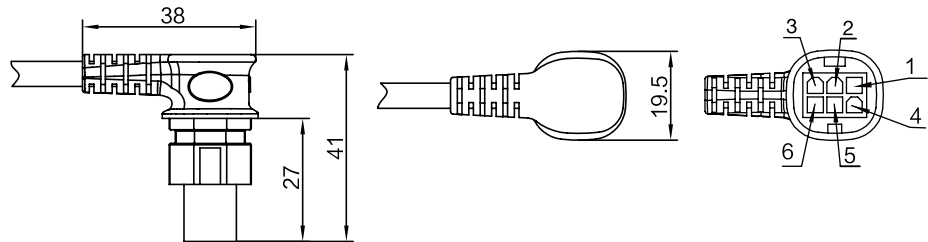





### **Strictly abiding by medical safety certifications**

Passed EMC tests. To ensure our products pass all kinds of tests domestic or abroad.



### **Communication protocol development**

Aiming at different applications, develop more extensive functions for control system.



### **Professional customization**

Powerful R&D strength, fully satisfy customers' needs. Development cycle is about 10 days, seizing more market opportunities



### **Intelligent Control of Bluetooth**

Mobile phone as the remote, applying in home care. Market pioneer, Jiecang provides better choices



### **Wireless Communication**

Controllers adopt high-frequency wireless system. It can avoid interference mixing with signal receivers, assisting in remote control over medical equipment.



### **Latest Weighing System**

Designed for physiotherapy beds and medical care beds. Cantilever carrying weighing sensor, it is applicable to different bedsteads dispensing with any adjustment



Notes for mounting and usage can be found in the corresponding mounting manual