

JC35DN Linear Actuator

Application field - Medical Line
 Preferably in medical bed, nursing bed, operating bed and other fields.

JC35DN is widely used with high performance and strong design. It has following specifications: JC35DN-6000N(push), JC35DN-4000N(push), JC35DN-3000N(push), JC35DN-2000N(push), JC35DN-1500N(push), JC35DN-1000N(push), JC35DN-750N(push).

JC35DN is characterized by large load capacity, strong design, low noise and high IP grade.



General Features

Load in push (N):	6000 4000 3000 2000 1500 1000 750
Motor rated voltage Input Input (VDC):	24
Installation dimensions:	L=225 (S ≤ 50) L=S+175 (50 < S < 400) L=S+195 (400 ≤ S < 600)
Stroke length:	6000N: 50-400mm (in steps of 4mm) 4000N: 50-400mm (in steps of 4mm) 3000N: 50-600mm (in steps of 4mm) 2000N: 50-600mm (in steps of 4mm) 1500N: 50-600mm (in steps of 4mm) 1000N: 50-600mm (in steps of 4mm) 750N: 50-600mm (in steps of 4mm)
Options:	Hall sensor, Only push, Reed switch
Colour:	Black (RAL 9005) / Grey (RAL 7035)
Limit switch:	Built-in (electrical)
Weight:	About 1.5kg (different stroke length and installation dimensions with different weight)
Duty cycle:	10%, max. 2min. continuous use
Max IP grade:	IP66
Noise level:	≤ 48dB (environmental noise ≤ 40dB)
Static bending moment:	Lateral load is not allowed
Flame retardant grade:	UL94-HB
Standards:	IEC60601-1: 2012 EN 60601-1: 2006+A12:2014 ANSI/AAMI ES60601-1:2005/(R)2012 and A1:2012, C1:2009/(R)2012 and A2:2010/(R)2012

Dimension Drawing

Top clevis D, end clevis D

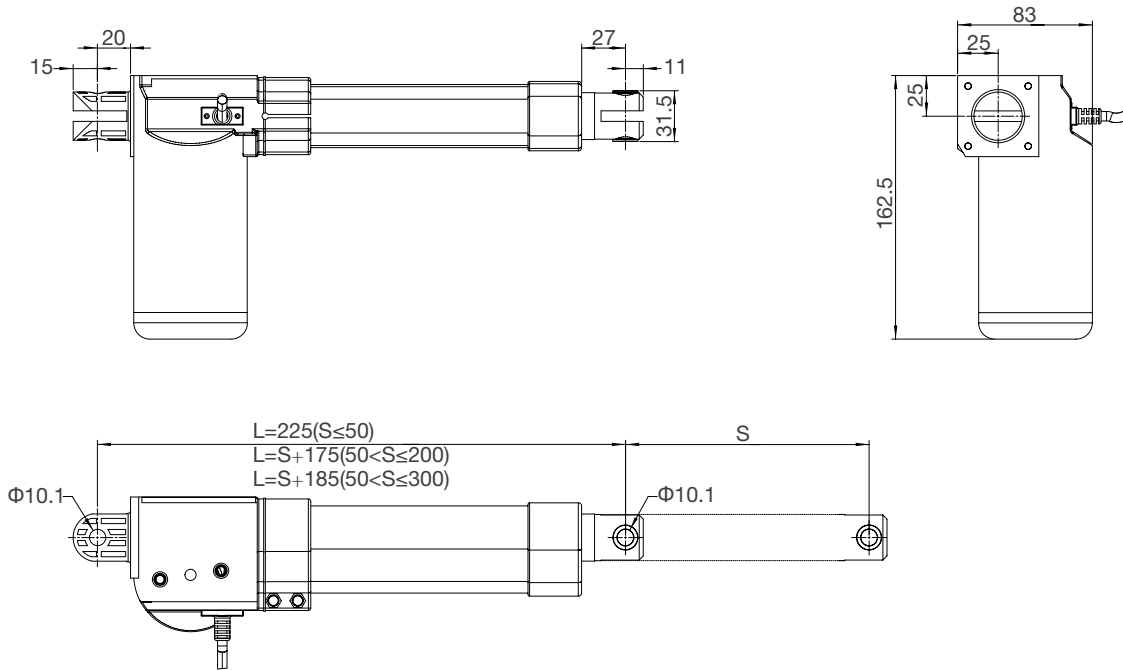

Top clevis A, end clevis D

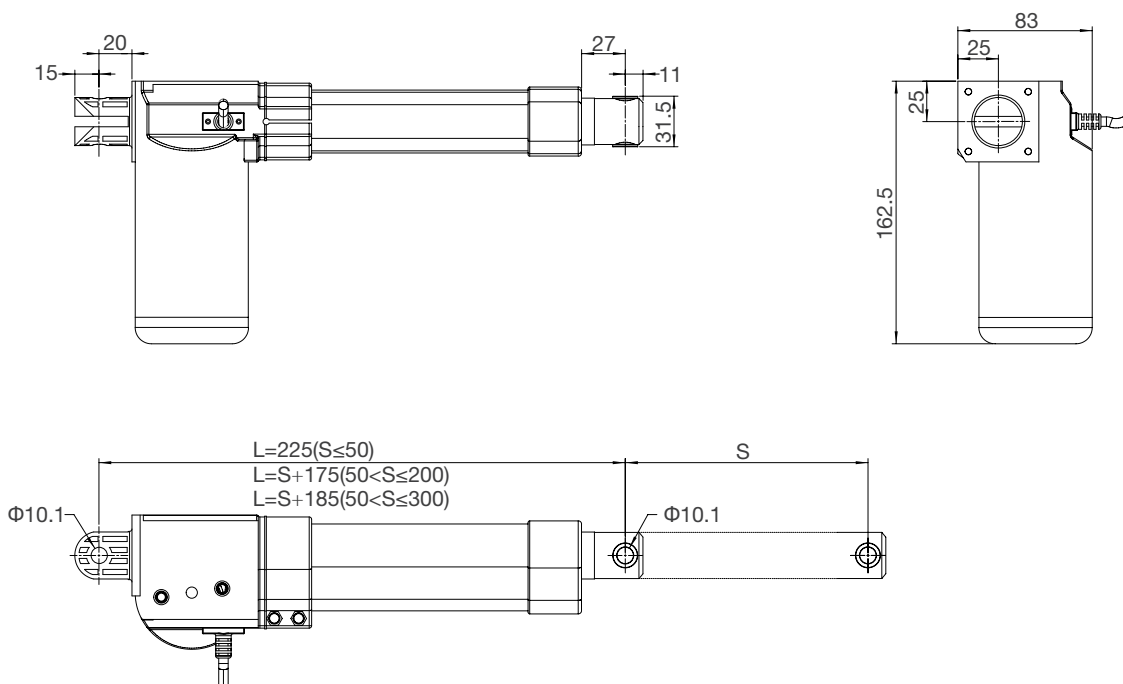

Technical parameters

Input voltage (VDC)	Spindle pitch (mm)	Max.Load capacity (N)	Self locking (N)	Speed no load (mm/s)	Speed full load (mm/s)	Current full load (A)
24	4	6000	6000	5.5	3	4.5
29	4	6000	6000	6.7	3.8	4.5
24	5	4000	4000	6.8	4	4
29	5	4000	4000	8.2	5.2	4
24	7.5	3000	3000	10	6	4
29	7.5	3000	3000	12	7.5	4
24	5	2000	2000	13	9	4
29	5	2000	2000	16	11	4
24	7.5	1500	1500	20.5	13	4.5
29	7.5	1500	1500	25	6.5	4.5
24	12	1000	1000	33	22	4
29	12	1000	1000	40	26	4
24	16	750	750	44	25	4
29	16	750	750	53	36	4

Remark: the above data are typical values at 25 °C

Stroke length versus load

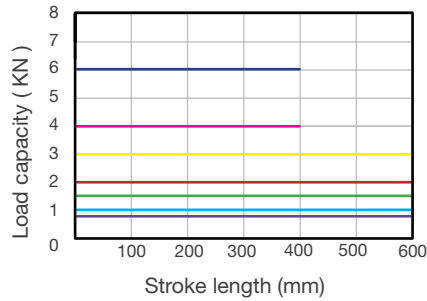

Characteristic

- Typical speed ————
- Min. speed - - - - -
- Typical current ————
- Max. current - - - - -

6000N

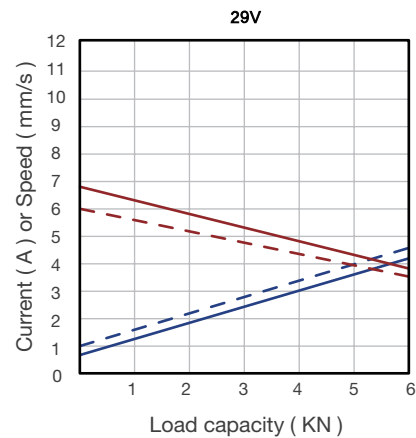
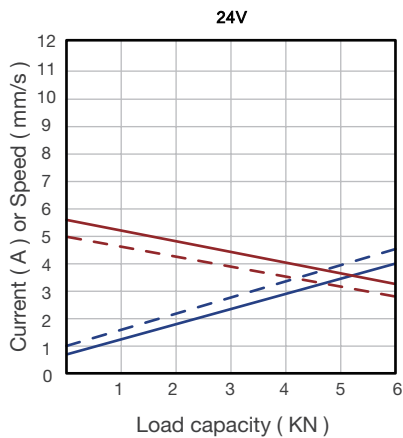

4000N

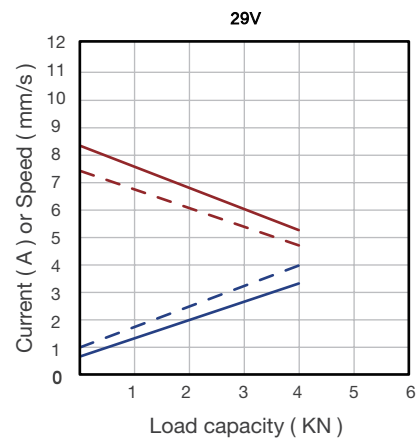
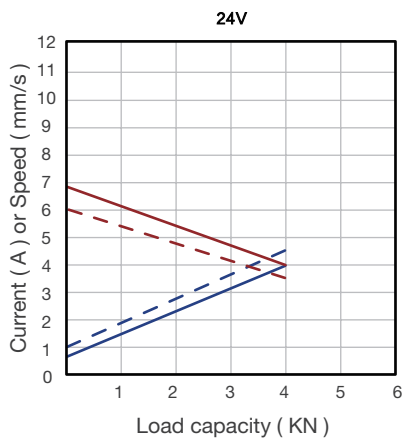

Typical speed ———
 Min. speed - - - -
 Typical current ———
 Max. current - - - -

3000N

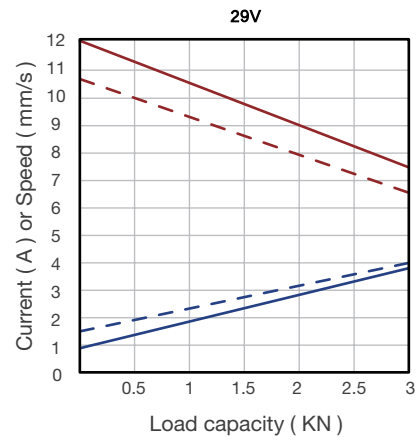
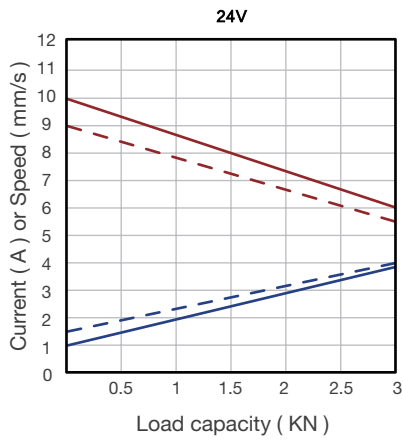

2000N

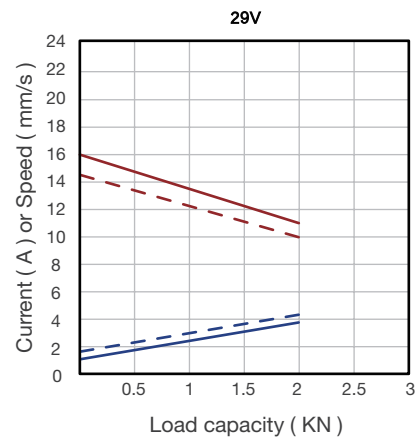
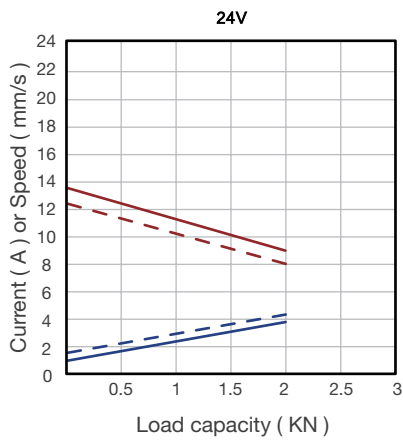

1500N

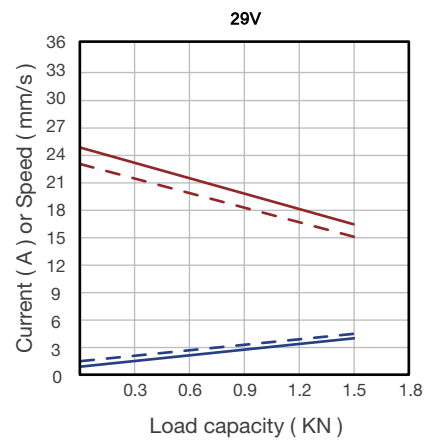
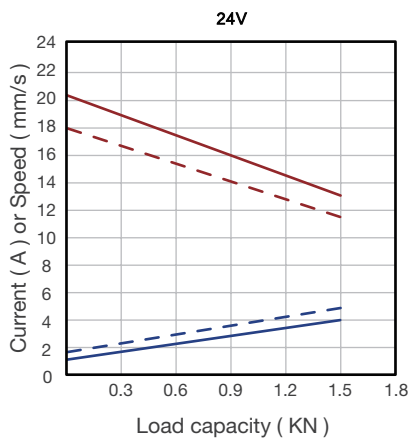

1000N

Typical speed ———
Min. speed - - - -
Typical current ———
Max. current - - - -

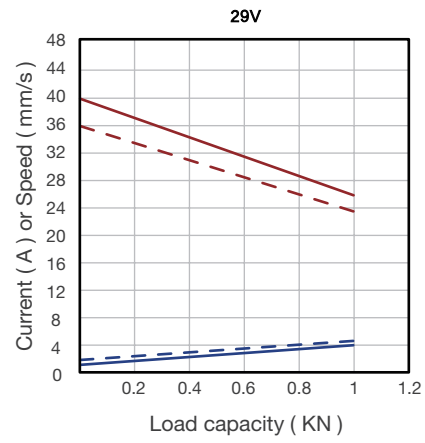
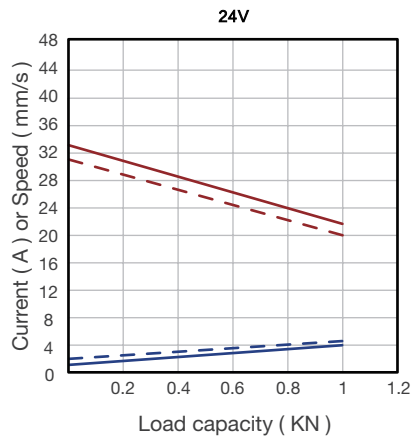

750N

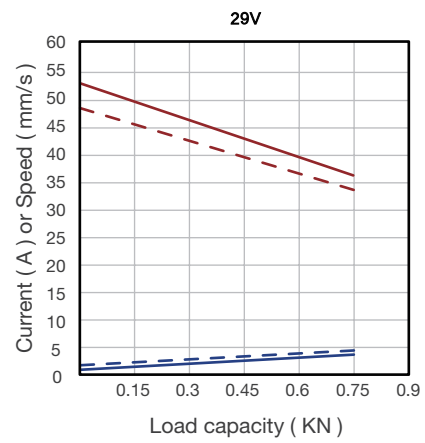
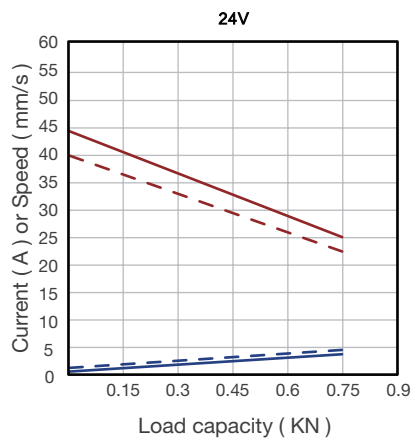

Ordering Key

Take **JC35DN06324150/325HGDZD2022D0** for example

Model	JC35DN	
Optional features	0	0 = Standard / P = Only push / Y = Hall sensor / R = Reed switch
Load in push	6	6 = 6000N / 4 = 4000N / 3 = 3000N / 2 = 2000N 1D5 = 1500N / 1 = 1000N / 0D75 = 750N
Speed at full load	3	3 = 3mm/s 4 = 4mm/s 6 = 6mm/s 9 = 9mm/s 13 = 13mm/s 22 = 22mm/s 25 = 25mm/s
Input voltage	24	24 = 24 VDC
Stroke length/ Installation dimension	150/325	Stroke length = XXX Installation dimension = XXX
Clevis directions	H	H = H direction / V = V direction
Color	G	G = Grey (RAL7035) / B = Black (RAL9005)
End clevis specification	D	D = Slot 6.5, hole diameter Φ 10.1
End clevis material	Z	Z = Zinc Aluminum alloy
Top clevis specification	D	A = Without slot, hole 10.1 with bushing D = Slot 6.5, hole 10.1 with bushing
Brake specification	2	0 = No brake 2 = Brake in push
Type of plug and cable	02	02 = 4-pin DIN plug 10 = 5-pin ET plug
Cable length	2D0	2D0 = 2m / 0D5 = 0.5m

Ordering Details

Dimension drawing of clevis

End clevis: D

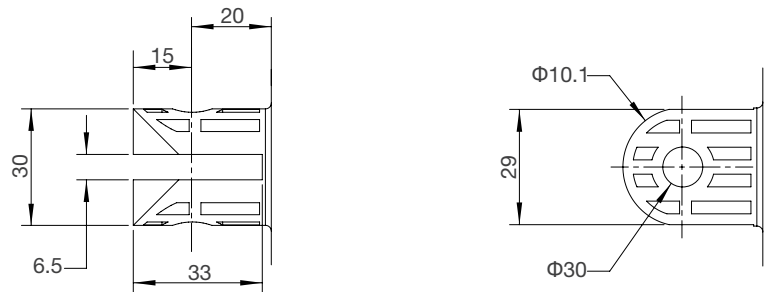

Top clevis: D

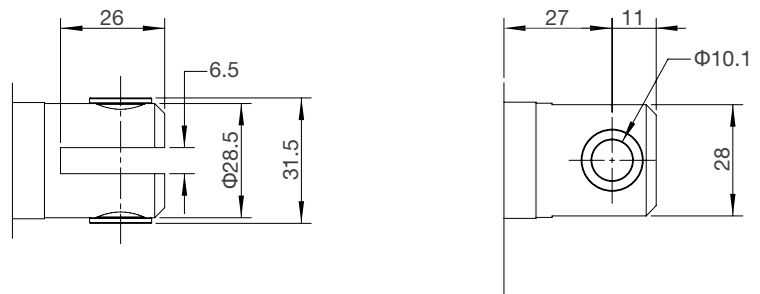

Top clevis: A

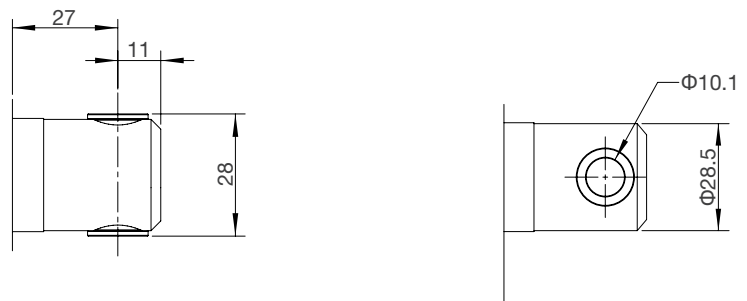

Dimensions JC35DN with control box

JCB35Q install on JC35DN

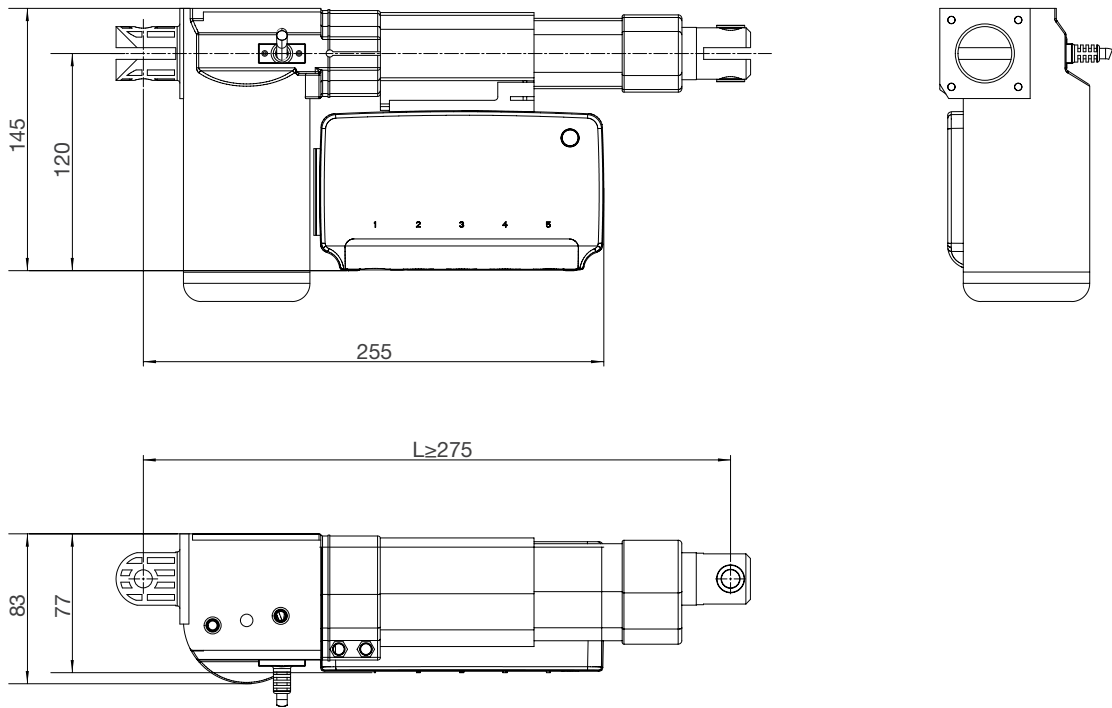

Motor wire

4-pin straight plug (standard)

Matching controller: JCB35Q/
JCB35T/ JCB35R/ JCB35R1/
JCB35S/ JCB35K2

Pin	Color	Function
1	NC	Not connected
2	Brown	When positive voltage power on, actuator will go down
3	Blue	When positive voltage power on, actuator will go up
4	NC	Not connected
Outer ring	NC	Not connected

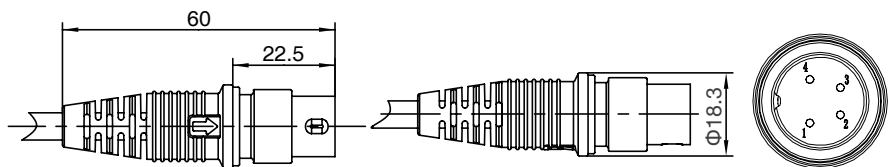

**5 pin DIN plug
(with Hall sensor)**

Matching controller: JCB35Q/
JCB35T/ JCB35R/ JCB35R1/
JCB35S/ JCB35K2



Pin	Color	Function
1	Red	5V
2	Brown	When positive voltage power on,actuator will go down
3	Black	GND
4	Blue	When positive voltage power on,actuator will go up
5	Yellow	Hall signal 1
Outer ring	Orange	Hall signal 2

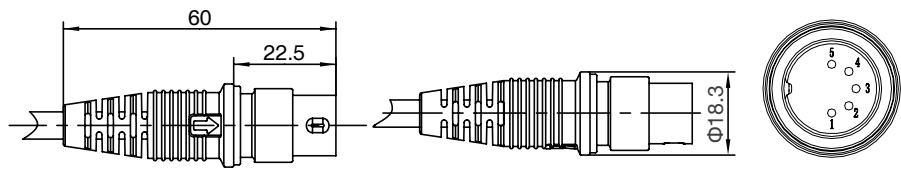



Strictly abiding by medical safety certifications

Passed EMC tests. To ensure our products pass all kinds of tests domestic or abroad.



Communication protocol development

Aiming at different applications, develop more extensive functions for control system.



Professional customization

Powerful R&D strength, fully satisfy customers' needs. Development cycle is about 10 days, seizing more market opportunities



Intelligent Control of Bluetooth

Mobile phone as the remote, applying in home care. Market pioneer, Jiecang provides better choices



Wireless Communication

Controllers adopt high-frequency wireless system. It can avoid interference mixing with signal receivers, assisting in remote control over medical equipment.



Latest Weighing System

Designed for physiotherapy beds and medical care beds. Cantilever carrying weighing sensor, it is applicable to different bedsteads dispensing with any adjustment



Notes for mounting and usage can be found in the corresponding mounting manual