Control Box

JCB35NS1



Data sheet

JCB35NS1

- The JCB35NS1 is a control box suitable for the TO series and single motor series.
- Add DC port, can be connected with specific accessories.
- Built-in six axis sensor, more sensitive to resistance and backsliding.
- Small size and beautiful shape.



Features

- Number of control columns: 1
- Color: Black
- House: ABS with snap structure, no screws
- Installing way: Can be fixed on the table plate or on the frame
- Overload protection: Set the limit value to avoid over burden motion
- Overheating protection

Option

- JCP35WA-A for wireless charging of mobile phones
- JCP35N-2.4G wireless receiver box, used to control column lifting by remote control
- JCP35N-BLT bluetooth receiving box, used to control the column lift through the mobile phone
- JCP35U USB charging case, used to charge electronic devices
- JCP35PA-B-3 battery box, used for portable office lifting table occasions

Usages

- Duty cycle: S1-10 min. Continuous work for most 2 minutes in a period of 20 minutes
- Ambient surrounding: Indoor

Technical specifications

- Size: 137×78×34mm
- Input voltage: 110-230V
- output power: 70W
- Standby power consumption: 0.1W
- Weight: 0.3kg

Dimensions

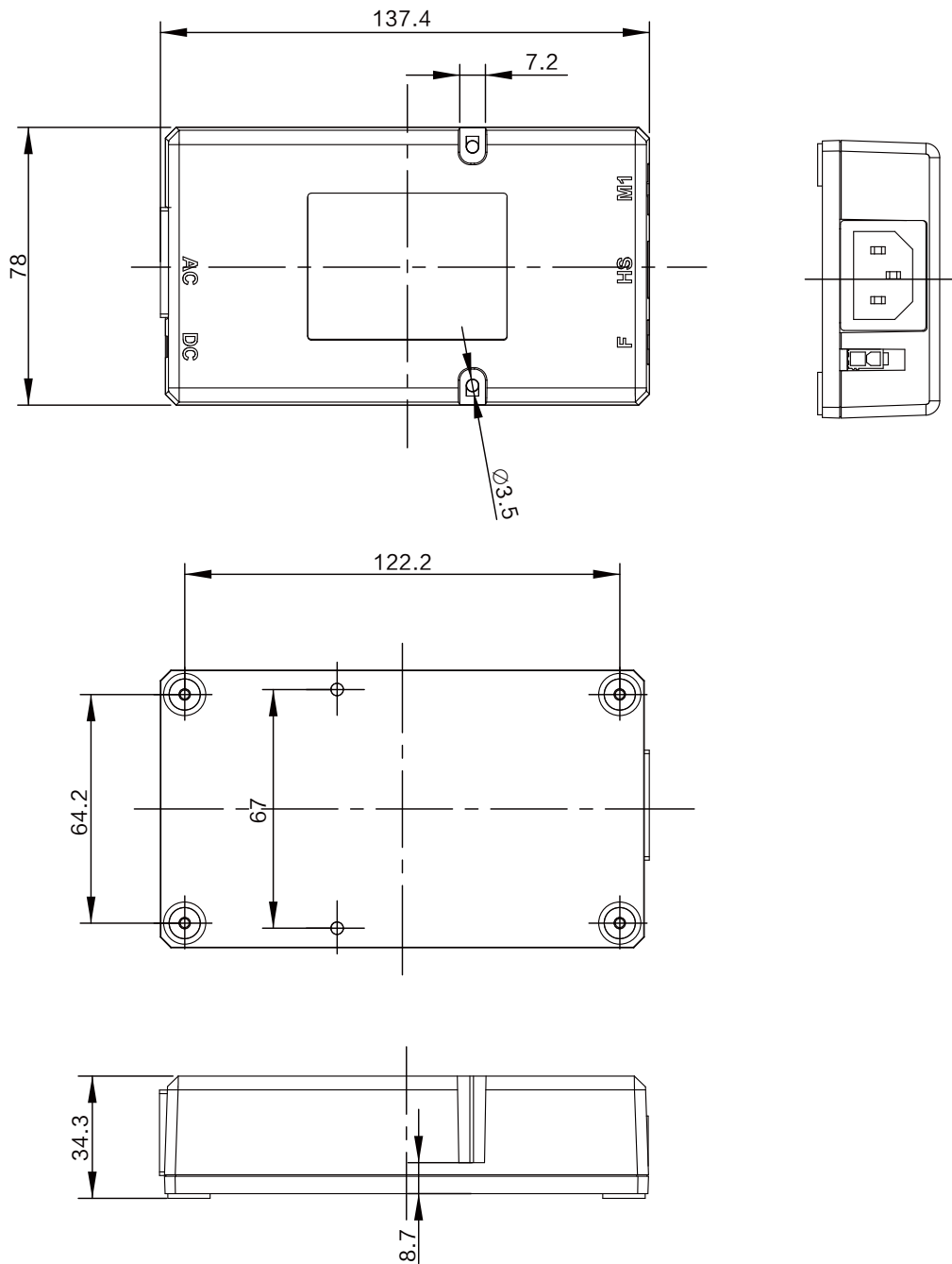

Ordering Key

JCB35NS1-1E8-3-M3-3D0-650(650)560(570)

